

Submit by Email

Print Form

Please note that this form will be sent as an xml data file.

Trafford Local Plan: Land Allocations "Call for Sites"

TRAFFORD
COUNCIL

Site information

Site address 1: Birch Farm, Partington

Site address 2:

Postcode (if known)

Ward (if known)

Has the land been previously developed?

Yes

No

Don't know

Site size (if known)

Please specify units of measurement

Existing use: Agricultural (Safeguarded Land)

Preferred use: Residential

Alternative use:

Contact details

Landowner

Name: Victoria Murray Organisation: Redrow

Site address 1: c/o agent

Site address 2:

Postcode:

Ward (if known)

Telephone:

Nature of interest (please select)

Email:

Freehold

Leasehold

Other interest

Name: John Coxon Organisation: Emergy Planning Partnership

Site address 1: 2-4 South Park Court, Hobson Street, Mandesfield

Site address 2:

Postcode: SK11 8BS

Ward (if known)

Telephone: 01625 433 881

Nature of interest (please select)

Email: support@epp-planning.com

Local resident

Agent

Other organisation

Site Issues

Sustainability

e.g. what kind of economic, social or environmental impacts could this site have?

Good Bad Don't know

Details:

Safeguarded land, no principle of development to meet long term needs is established. Site could be delivered to meet any shortfall in housing land supply should any of the strategic sites fail to deliver at the expected rates.

Deliverability

e.g. are there any constraints on development?

Good Bad Don't know

Details:

No constraints to development. Site under control of a housing developer.

Site plans

It is necessary to submit a plan on an OS map base, with the proposed site edged in blue - this is an essential requirement. You can submit either an image file or a pdf file along with this submission form by simply attaching it to your email once you click the '**Submit by email**' button at the top of this form.

Please submit your completed form(s) either electronically or by printing it out and sending it to Strategic Planning and Developments, Waterside house, Sale Waterside, Sale, Manchester, M33 7ZF by 5:00pm Friday 14th September 2012.

If you wish to be kept informed about progress on the Trafford Local Plan: Land Allocations, please indicate by clicking this box, alternatively check the Council website www.trafford.gov.uk for updates.

Please note: All comments will be held by the Council on a database for the duration of the Local Plan and will be available for public inspection under the Freedom of Information Act 2000.

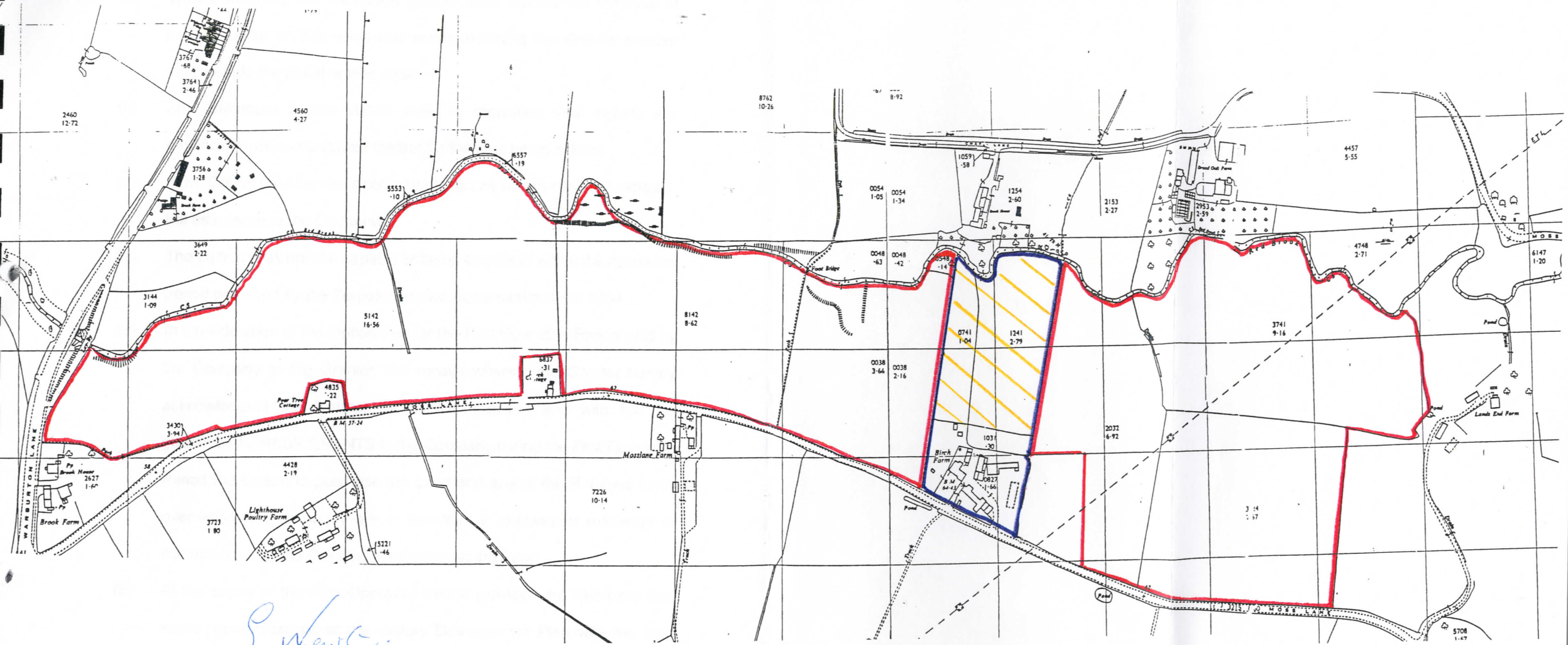

P. New C.
M. Newton