

PROPOSED HYDROBRAKE MANHOLE 1500mm DIAMETER IN S11 TO CATER FOR THE REQUIRED MODEL RESTRICTING SURFACE WATER DISCHARGE TO SL/S FOR THE 1 IN 100 YEAR +40% CLIMATE CHANGE DIRECTIVE ENVISAGED. THE GEO-CELL STORAGE FACILITY REQUIRED FOR THE 45m3 REQUIRED IS 11mL x 5mW x 0.88mH

PROPOSED NEW ON-SITE COMBINED MANHOLE REF: CMH1 TO CONNECT INTO EXISTING UU MANHOLE SUBJECT TO UNITED UTILITIES PART 1 & 2 SEWER CONNECTION APPROVALS.

REVISIONS		
Rev.	Date	By
A	15-07-2022	DM5

- KEY:**
- Site Boundary 0.215Ha
 - Proposed Finished Floor Level - Apartments **FFL 25.100**
 - Existing Public UU Combined Sewer
 - Proposed Private Foul water Sewer, Manhole, pipe size, CL/IL
 - Proposed Private Surface water Sewer, Manhole, pipe size, CL/IL
 - Proposed Geo-storm Cell
 - Proposed Catchpit Manhole with SL (Sump Level)
 - Proposed Tree Harvesting Catchpit Manhole & Diameter
 - Proposed Drainage Channel
 - Existing Contours
 - Proposed Porous Block Paving, stone & Membrane Blanket surround
 - Proposed Porous Bitmac Surface, stone & Membrane Blanket surround
 - Proposed Tree Pits
 - Proposed Water Butt

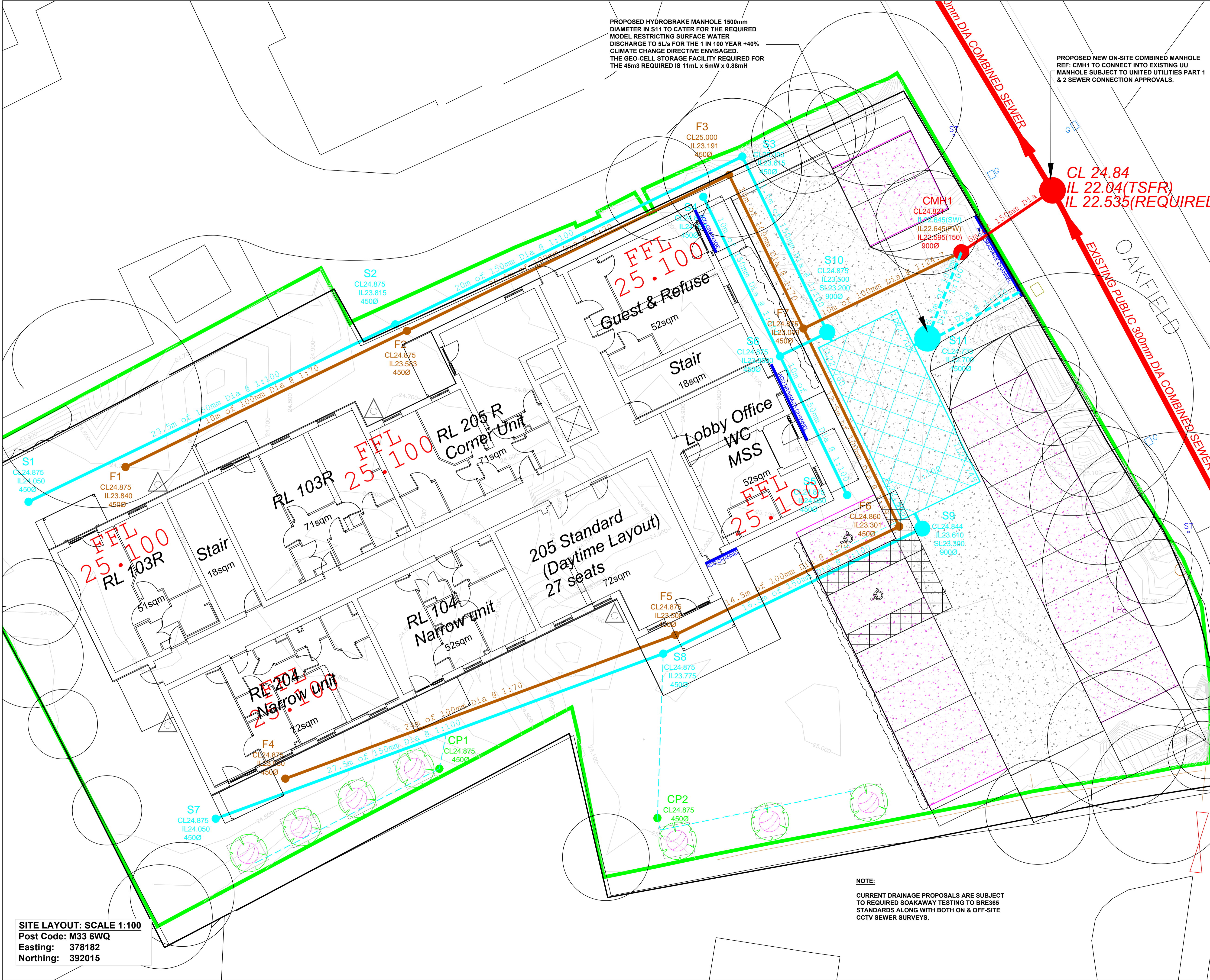

NOTE:
CURRENT DRAINAGE PROPOSALS ARE SUBJECT TO REQUIRED SOAKAWAY TESTING TO BRE365 STANDARDS ALONG WITH BOTH ON & OFF-SITE CCTV SEWER SURVEYS.

SITE LAYOUT: SCALE 1:100
Post Code: M33 6WQ
Easting: 378182
Northing: 392015

Project Title	
Land off Oakfield	
Site	
Manchester	
M33 6WQ	
Drawing Title	
Proposed Drainage Layout	
Scale: 1:100@A1	Date: 15 July 2022
Drawn: DM5	Checked:
Drawing No.	
McC&S-OR-S-DEV-100-004	A

© McCarthy & Stone Retirement Lifestyles Limited
All rights reserved. The reproduction of all or any part of this drawing without the prior written consent of McCarthy & Stone Retirement Lifestyles Limited is prohibited.
ALL DIMENSIONS TO BE CHECKED ON SITE. WORK TO PROPOSED DIMENSIONS ONLY. REPORT DISCREPANCIES TO THE ARCHITECT AT ONCE BEFORE PROCEEDING.