

**Appendix 3.15 - Tree removal
and protection plan
(D6370.01.002B) (29 Sept 2020)**

Payne, Hannah

From: Hard, Matt
Sent: 29 September 2020 16:49
To: Debra Harrison [REDACTED]
Cc: Welch, Victoria; Hann, Doug; Payne, Hannah; Mark Levitt
Subject: FW: Former B&Q - Tree queries
Attachments: D6370.01.002B Tree Removal and Protection Plan.pdf

Debra

Further to our conversation and your email, I attach the updated tree plan. You'll note a commentary from the arboriculturalist below.

This was undertaken upon receipt of the TFGM comments, but as you didn't specifically request anything further, we assumed this was a matter between Accrue and TfGM as landowners and didn't submit it to you previously.

I hope this is sufficient?

Kind regards

Matthew Hard BA(Hons) MSc MRTPI

Associate Director

From Monday 4 May WSP | Indigo becomes WSP and my email address will change to matthew.hard@wsp.com. As part of WSP, we will continue to provide our clients with the same personalised service, and access to our wider expertise across the business. To find out more please visit wsp.com/planning-consultancy



[REDACTED]
[REDACTED]
[REDACTED]

8 First Street, Manchester
M15 4RP

www.wsp.com/en-GB/campaigns/planning-consultancy

Confidential

This message, including any document or file attached, is intended only for the addressee and may contain privileged and/or confidential information. Any other person is strictly prohibited from reading, using, disclosing or copying this message. If you have received this message in error, please notify the sender and delete the message. Thank you.

WSP UK Limited, a limited company registered in England & Wales with registered number 01383511. Registered office: WSP House, 70 Chancery Lane, London, WC2A 1AF.

From: Welch, Victoria <[REDACTED]>
Sent: 29 September 2020 16:44
To: Hard, Matt <[REDACTED]>
Subject: FW: Former B&Q - Tree queries

Victoria Welch BSc(Hons), MA

Planner

From Monday 4 May WSP | Indigo becomes WSP and my email address has now changed to victoria.welch@wsp.com. As part of WSP, we will continue to provide our clients with the same personalised service, and access to our wider expertise across the business. To find out more please visit wsp.com/planning-consultancy.

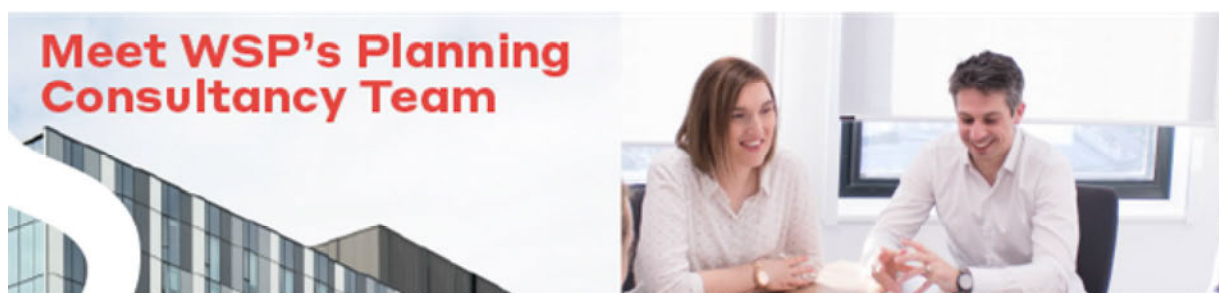

wsp

[REDACTED]

8 First Street
Manchester
M15 4RP

www.wsp.com/en-GB/campaigns/planning-consultancy

Confidential

This message, including any document or file attached, is intended only for the addressee and may contain privileged and/or confidential information. Any other person is strictly prohibited from reading, using, disclosing or copying this message. If you have received this message in error, please notify the sender and delete the message. Thank you.

WSP UK Limited, a limited company registered in England & Wales with registered number 01383511. Registered office: WSP House, 70 Chancery Lane, London, WC2A 1AF.

From: Mark Levitt <[REDACTED]>
Sent: 13 August 2020 18:17
To: Welch, Victoria <[REDACTED]>; Guy Pearson-Gregory <[REDACTED]>
Cc: Payne, Hannah <[REDACTED]>; Hard, Matt <[REDACTED]>; Heather Eilbeck <[REDACTED]>
Subject: RE: Former B&Q - Tree queries

Dear Vicky,

Please find attached our updated Tree Constraints Plan (ref: D6370.01.001B) showing additional tree stems plotted within G1 on the Metrolink land. I have only plotted the most significant trees, the remainder are either too small or too far away from the application site boundary to have roots within the site.

As suspected from our original survey, very few trees have Root Protection Areas that extent beyond the soft verge within which the on-site trees are growing. In reality the presence of the existing hard-surfacing, which is of substantial nature, almost up to the boundary fence will have been impeded tree root growth to the northwest. Whilst some roots may have extended a small amount into the site, the vast majority will have favoured the softer ground

within the Metrolink land. Our conclusion therefore, on the likelihood of damage being caused to the trees and the need for protection during construction, remains the same as previously reported.

Included as a notation on drawing D6370.01.002 - Tree Removal and Protection Plan included within our AIA report (ref: 6370.01.003, v3.0 March 2020) is a description of what is considered adequate protection for the offsite trees throughout the construction process:

It is assumed that the existing metal boundary fence and/or site hoarding fencing will provide sufficient protection to group G1. If site hoarding is not erected and the existing metal fencing is removed, additional tree protection measures will be required.

I hope the above text and attached plan are sufficient to allow you to respond to the consultation comment, but if you would like us to prepare a statement on your behalf we would be happy to do so.

Kind regards,
Mark

Mark Levitt
Arboricultural Consultant



Warrington | Gateshead | Market Harborough | London | Cornwall
01925 844004 | 0191 605 3340 | 01858 383120 | 0203 096 6050 | 01326 240081



How Biodiverse is Greater Manchester?

Our GIS and Ecology teams mapped and scored over 131,000ha across the city to find out!

[>To learn how we did it click here](#)

Please consider the environment before printing this email

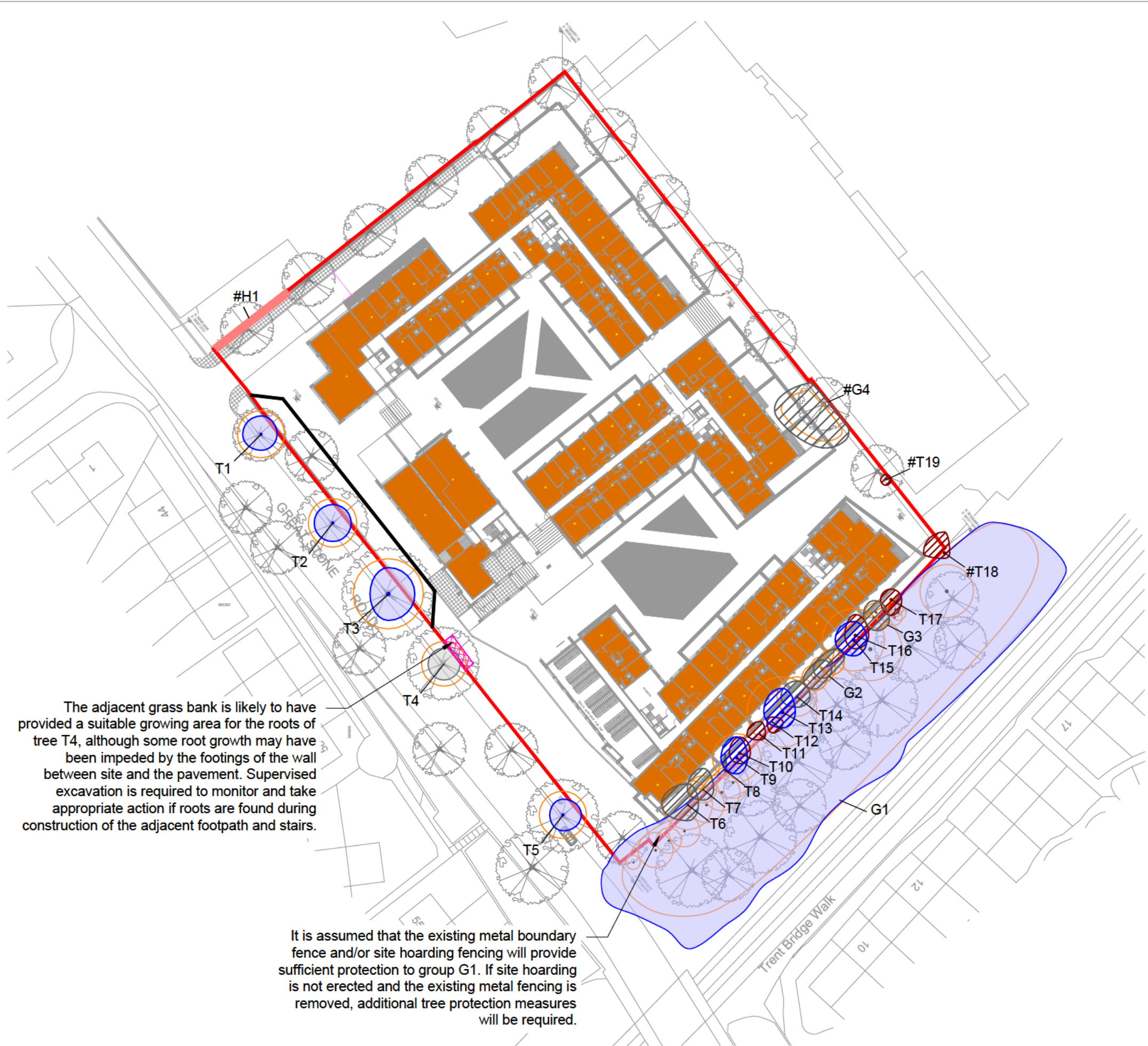

KEY

[This drawing must be reproduced in colour]

- T1 Individual trees
- G1 Groups of trees
- Application Boundary
- Approximate location (Feature not shown on topo)
- Tree Protection Fencing (c. 70.5m or 21 Heras Panels) (Must be installed prior to works commencement)
- Supervised Excavation (When the build programme has been drafted, the Site Manager will appoint an Arboricultural Consultant to supervise excavation works.)

Trees to be retained

- Category B (Moderate quality)
- Category C (Low quality)
- Category U (Trees with existing or potential conservation value)
- H1 Hedgerow (Not categorised)

Trees to be removed

- Category B (Moderate quality)
- Category C (Low quality)
- Category U (Unsuitable for retention)
- Hedgerow (Not categorised)

NOTE: Tree quality assessment based on BS 5837:2012 Trees in relation to design, demolition and construction - Recommendations.

NOTE: This drawing should be read in conjunction with the respective Arboricultural Data Sheets (Appendix A).



| | | | | |
|-----|--|-------|----------|------------|
| B | Additional stems and RPAs plotted; updated layout | ML | JGS | 18.08.2020 |
| A | Updated proposals, tree removals and red line boundary | HEE | JGS | 10.02.2020 |
| Rev | Description | Drawn | Approved | Date |



Genesis Centre, Birchwood Science Park, Warrington WA3 7BH
Tel 01925 844004 e-mail tep@tep.uk.com www.tep.uk.com

Project
Great Stone Road, Stretford
Arboricultural Impact Assessment
Title
Drawing 2: Tree Removal and Protection Plan

Drawing Number
D6370.01.002B

| | | | | |
|-------|---------|----------|------------|------------|
| Drawn | Checked | Approved | Scale | Date |
| TDR | AAB | JGS | 1:750 @ A3 | 19/02/2018 |

The adjacent grass bank is likely to have provided a suitable growing area for the roots of tree T4, although some root growth may have been impeded by the footings of the wall between site and the pavement. Supervised excavation is required to monitor and take appropriate action if roots are found during construction of the adjacent footpath and stairs.

It is assumed that the existing metal boundary fence and/or site hoarding fencing will provide sufficient protection to group G1. If site hoarding is not erected and the existing metal fencing is removed, additional tree protection measures will be required.