

This drawing is to be read in conjunction with all other relevant technical information, statutory approvals, specifications and 3rd party information. Do not scale from this drawing. Use only dimensions provided. All dimensions and levels to be checked on site and all discrepancies must be reported to the drawings author immediately. Responsibility cannot be accepted for alteration and/or deviation from this design without the prior acknowledgement of the drawings author. Any commercial decisions relating to this information must make due allowance for dimensional and area variation resulting from the design development and construction processes as well as the requirements of statutory authorities. This drawing is to be used only for the purposes indicated. This drawing is copyright and the property of Northmill Associates Ltd (NMA) and must not be reproduced without prior written agreement. Any Intellectual Property rights (IPR) relating to the design(s) described in this drawing belong to the originating designer and, where it is not NMA's design, no credit for the design or IPR is sought by this drawings author.

- Application Boundary
- Existing Buildings With Area
- Previously Developed Land

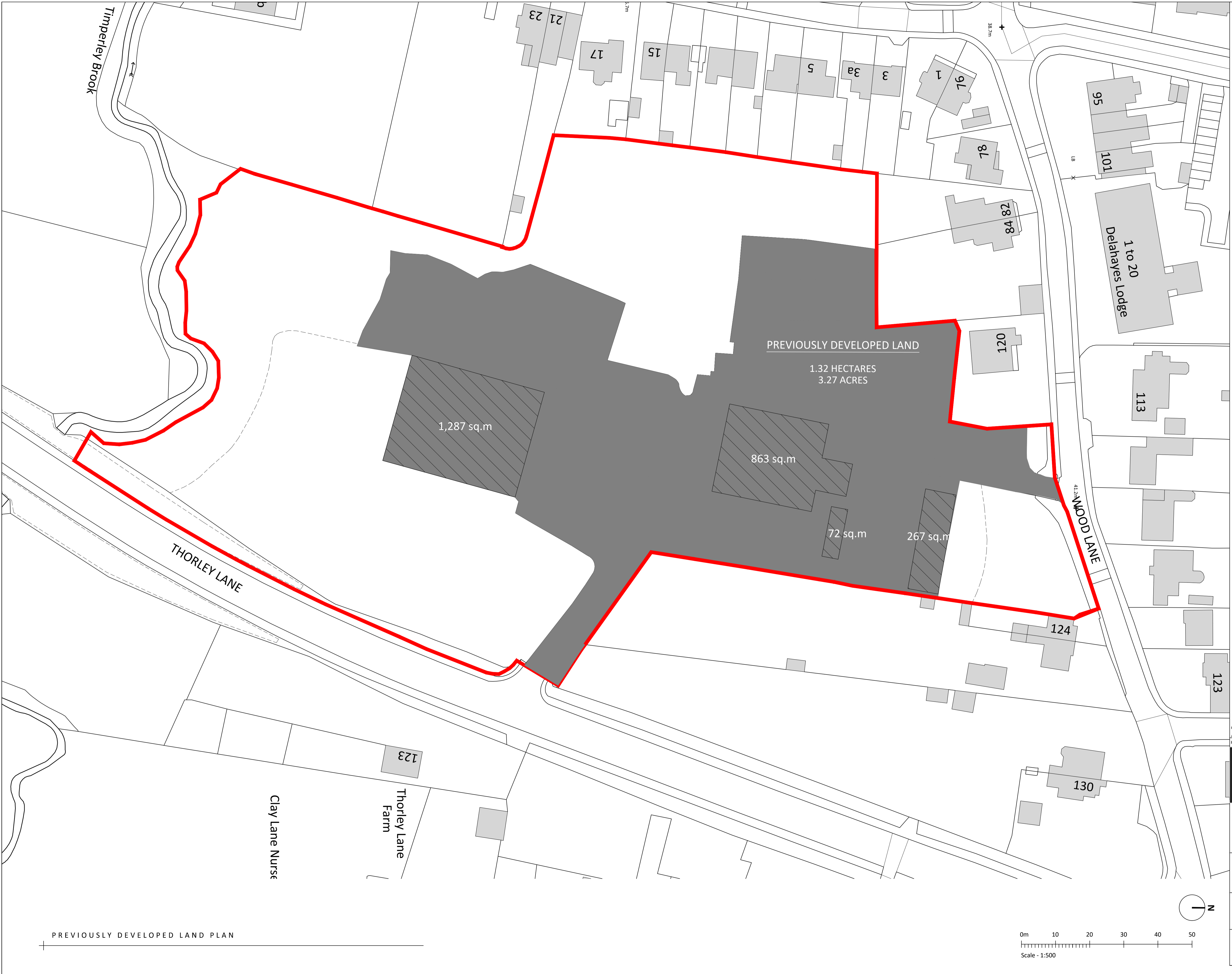

B	AREA CHANGES, LEGEND EXPANDED, INTERNAL BOUNDARY	RET	JS	20/01/2020
A	REMOVED	RET	JS	22/12/2020
Rev	Description	By	Chk	Date

NORTHMILL
associates

Suite 3 6th Floor 55 King Street Manchester M2 4JQ
0161 224 4411
nma@northmillassociates.com

Project
WORLD OF PETS LEISURE SITE
Thorley Lane
Timperley

Client
Harlex Properties

Drawing		
Previously Developed Land Plan		
<hr/>		
Project No: Spec	Scale @ A1 1:500	Date: 10/08/2018
Drawn: TP	Checked: HD	Status: PRELIMINARY
Drawing No:	Revision:	
L(00)001	B	

PREVIOUSLY DEVELOPED LAND PLAN