

**THE TRANSPORT FOR GREATER MANCHESTER (LIGHT RAPID TRANSIT SYSTEM)
(TRAFFORD PARK EXTENSION) ORDER 2016**

**BOROUGH OF TRAFFORD (SIR ALEX FERGUSON WAY SLIP ROAD BETWEEN
WHARFSIDE WAY AND THE MAIN CARRIAGEWAY OF SIR ALEX FERGUSON WAY,
TRAFFORD PARK) (ONE-WAY AND PROHIBITION OF RIGHT TURN)
ORDER 2018 – Ref TPL-TWAO-08**

NOTICE IS HEREBY GIVEN that pursuant to the provisions of Article 42 of The Transport for Greater Manchester (Light Rapid Transit System) (Trafford Park Extension) Order 2016, Transport for Greater Manchester (TfGM) intends to make an Order the effects of which will be to:-

Introduce One Way Traffic on Sir Alex Ferguson Way slip road between Wharfside Way and the main carriageway of Sir Alex Ferguson Way, Trafford Park from its junction with Wharfside Way to its junction with the main carriageway of Sir Alex Ferguson Way in a north easterly direction.

Prohibit the Right Turn from Sir Alex Ferguson Way slip road between Wharfside Way and the main carriageway of Sir Alex Ferguson Way into Sir Alex Ferguson Way/Victoria Place

The Order will come into force on the 16th day of April 2018

There is no right of objection to the making of the Order but if you have any queries regarding the Order and the Powers under which it has been made please write to Metrolink, TfGM, 2 Piccadilly Place, Manchester, M1 3BG

DATED this 2nd day of April 2018

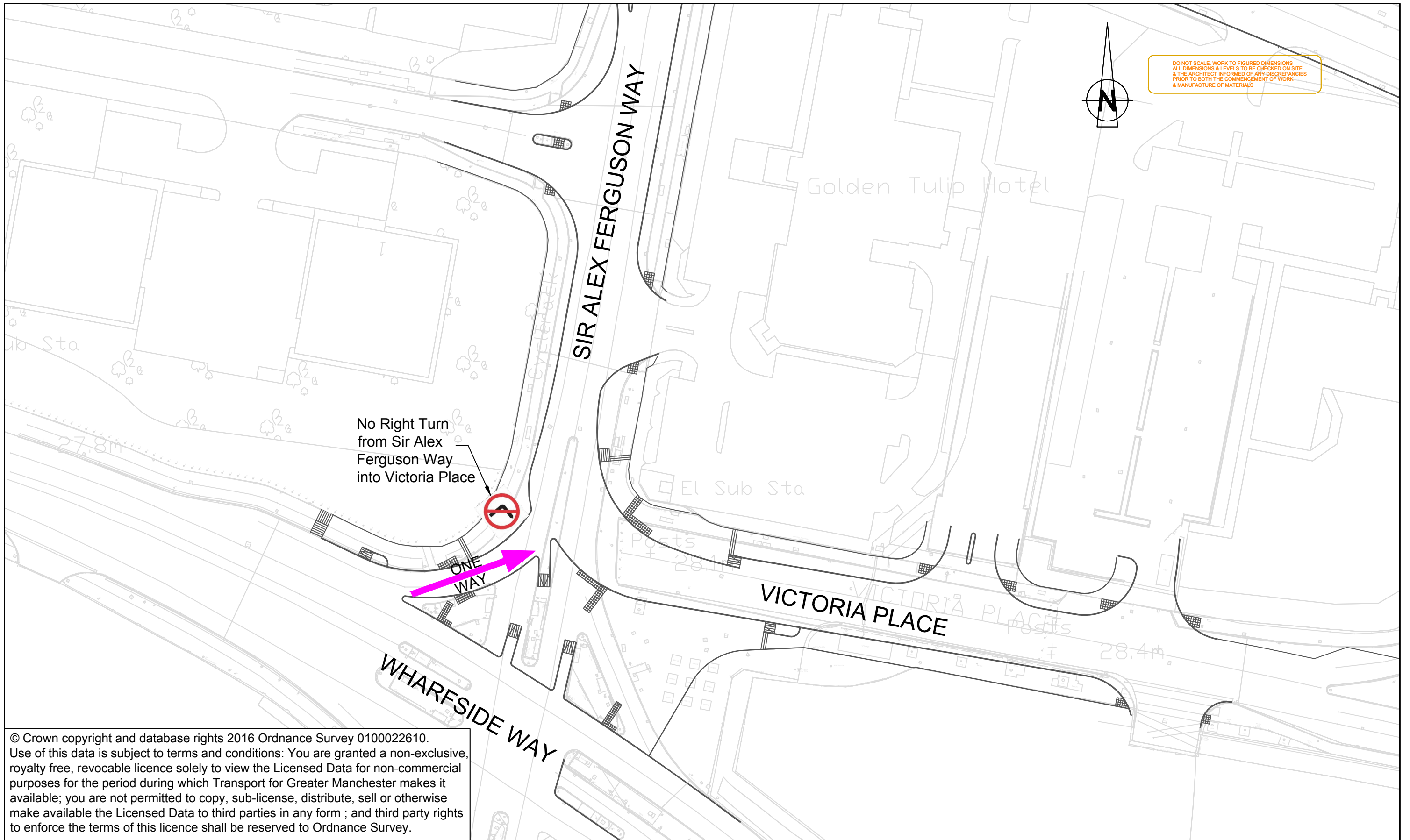

© Crown copyright and database rights 2016 Ordnance Survey 0100022610.
Use of this data is subject to terms and conditions: You are granted a non-exclusive, royalty free, revocable licence solely to view the Licensed Data for non-commercial purposes for the period during which Transport for Greater Manchester makes it available; you are not permitted to copy, sub-license, distribute, sell or otherwise make available the Licensed Data to third parties in any form ; and third party rights to enforce the terms of this licence shall be reserved to Ordnance Survey.

Client
Transport for Greater Manchester
2 Piccadilly Place
Manchester
M1 3BG
Tel. 0161 244 1000
Fax. 0161 244 1316

KEY

One Way Traffic

No Right Turn

Issue	Date	Drawn	Description	Ch'k'd	App'd	Title	Drawn	LG
A	27/03/2018	LG	Initial Issue			MANCHESTER METROLINK TRAFFORD PARK LINE	Checked	
						Traffic Regulation Order TPL 008 One Way and No Right Turn - Sir Alex Ferguson Way	Approved	
						Drawing No. TfGM-TPL-LG-TRO-008	Scale NTS	
							Issue	Date
							A	27/03/18