

**THE TRANSPORT FOR GREATER MANCHESTER (LIGHT RAPID TRANSIT SYSTEM)  
(TRAFFORD PARK EXTENSION) ORDER 2016**

**BOROUGH OF TRAFFORD (SECOND AVENUE, TRAFFORD PARK)  
(TEMPORARY PROHIBITION OF DRIVING) ORDER 2018 – Ref TPL 0057**

**NOTICE IS HEREBY GIVEN** that pursuant to the provisions of Article 42 of The Transport for Greater Manchester (Light Rapid Transit System) (Trafford Park Extension) Order 2016, Transport for Greater Manchester (TfGM) intends to make a Temporary Traffic Regulation Order, the effect of which will be to prohibit driving, except for emergency service vehicles (in the case of an emergency and for statutory undertakers in pursuance of statutory powers as follows:-

**Prohibition of Driving**

<b>Road Name</b>	<b>Length Affected</b>
Second Avenue, Trafford Park	From a point 45 metres north of its junction with Westinghouse Road to its junction with Westinghouse Road

The reason for the Order is to facilitate the diversion of Statutory Undertakers apparatus.

The alternative routes for traffic requiring access to Second Avenue will be:-

- for traffic travelling east on Westinghouse Road via Europa Way, Eighth Street, First Avenue and Sixth Street;
- for traffic travelling west on Westinghouse Road via Third Avenue and Fifth Street;
- for traffic travelling south on Second Avenue via Sixth Street, First Avenue, Eighth Street, Europa Way and Westinghouse Road or via Fifth Street, Fifth Avenue and Westinghouse Road.

The Order will come into operation on 17<sup>th</sup> May 2018 and will remain in force until the safe completion of the works which is expected to be approximately 1 week.

Dated: 9<sup>th</sup> May 2018

Transport for Greater Manchester  
2 Piccadilly Place,  
Manchester  
M1 3BG

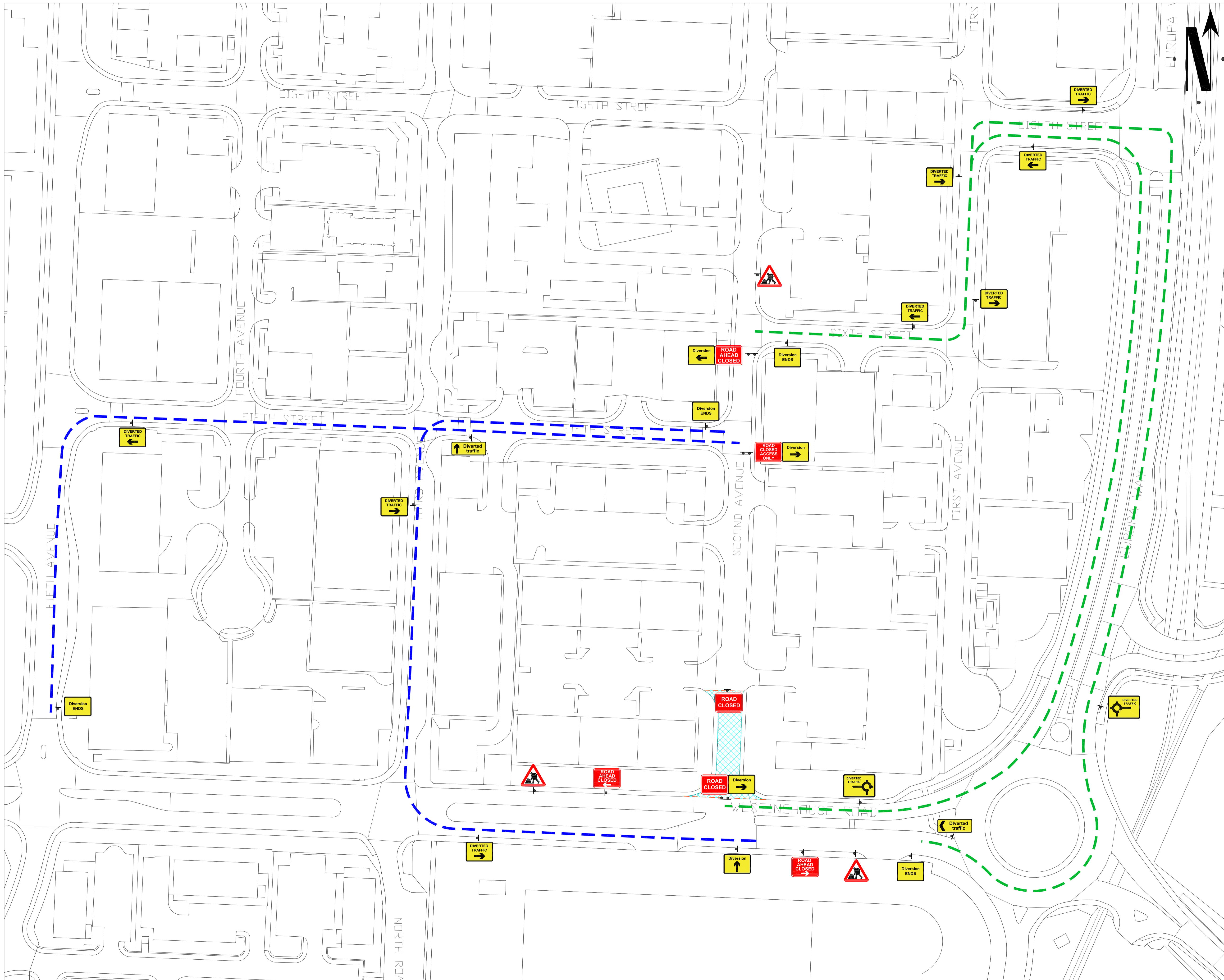

**TRAFFIC MANAGEMENT PLAN**

**NOTES:**

1. All signs as per Chapter 8. Distances between cones to be 9m maximum unless otherwise noted.
2. Distances between signs NOT to scale for purpose of clarity.
3. All sign placement subject to available safe working space.
4. The purpose of the Traffic Management Plan is for it to be used only as a guide and all traffic management equipment should be put out according to the 'Safety at Street Works and Road Works - Code of Practice', i.e. Red Book & the 'Traffic Signs Manual Chapter 8' i.e. Yellow Book

**Key**

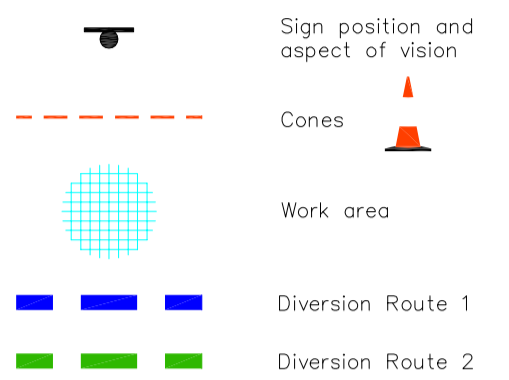

This drawing has been produced for a specific project & client identified below and is not intend for use by any other person or for any other purpose

Rev	Description	Date
01	First issue for comment	17.04.18
02	Updated diversion route	09.05.18

CODE	SUITABILITY DESCRIPTION
------	-------------------------

STATUS	PURPOSE OF ISSUE
--------	------------------



PROJECT  
**Manchester Metrolink Phase 3**

TITLE  
**Second Avenue, Stretford  
Section 3.2  
Trafford Park Line  
Stats Diversion Works**



DRAWN BY C. Powell	CHECKED BY L. Pilling	DATE 09/05/2018
-----------------------	--------------------------	--------------------

NTS All dimensions to be verified on site	PROJECT NUMBER MPT3
---	------------------------

DRAWING NUMBER 33121-3.2-003	REV 02
---------------------------------	-----------