

**THE TRANSPORT FOR GREATER MANCHESTER (LIGHT RAPID TRANSIT SYSTEM)
(TRAFFORD PARK EXTENSION) ORDER 2016**

**BOROUGH OF TRAFFORD (VILLAGE WAY, TRAFFORD PARK)
(TEMPORARY ONE WAY TRAFFIC) ORDER 2019 – Ref TPL 0123**

NOTICE IS HEREBY GIVEN that pursuant to the provisions of Article 42 of The Transport for Greater Manchester (Light Rapid Transit System) (Trafford Park Extension) Order 2016, Transport for Greater Manchester (TfGM) intends to make a Temporary Traffic Regulation Order, the effect of which is to introduce one way traffic working as follows:-

One-way traffic

Column 1 Road Name and length	Column 2 Direction of Travel
Village Way, Trafford Park	from its junction with Parkway Circle to its junction with Mosley Road, an easterly direction.
Village Way, Trafford Park	from its junction with Fifth Avenue to its junction with Village Circle an easterly direction.

The reason for the Order is to complete the construction of the Trafford Park Metrolink Extension.

The alternative routes for westbound traffic will be via Europa Way, Westinghouse Road and Parkway Circle or Trafford Park Road, Tenax Way and Parkway Circle

The Order will come into operation on 15th September 2019 and is expected to remain in force for a period 10 weeks or until the safe completion of the works. The effects of this Order will only be in force as when signs are displayed to that effect.

From the 15th September 2019, this order will supersede Ref TPL 0006 currently prohibiting all traffic westbound traffic on Village Way.

Dated: 3rd day of Sept 2019

Transport for Greater Manchester
2 Piccadilly Place,
Manchester
M1 3BG

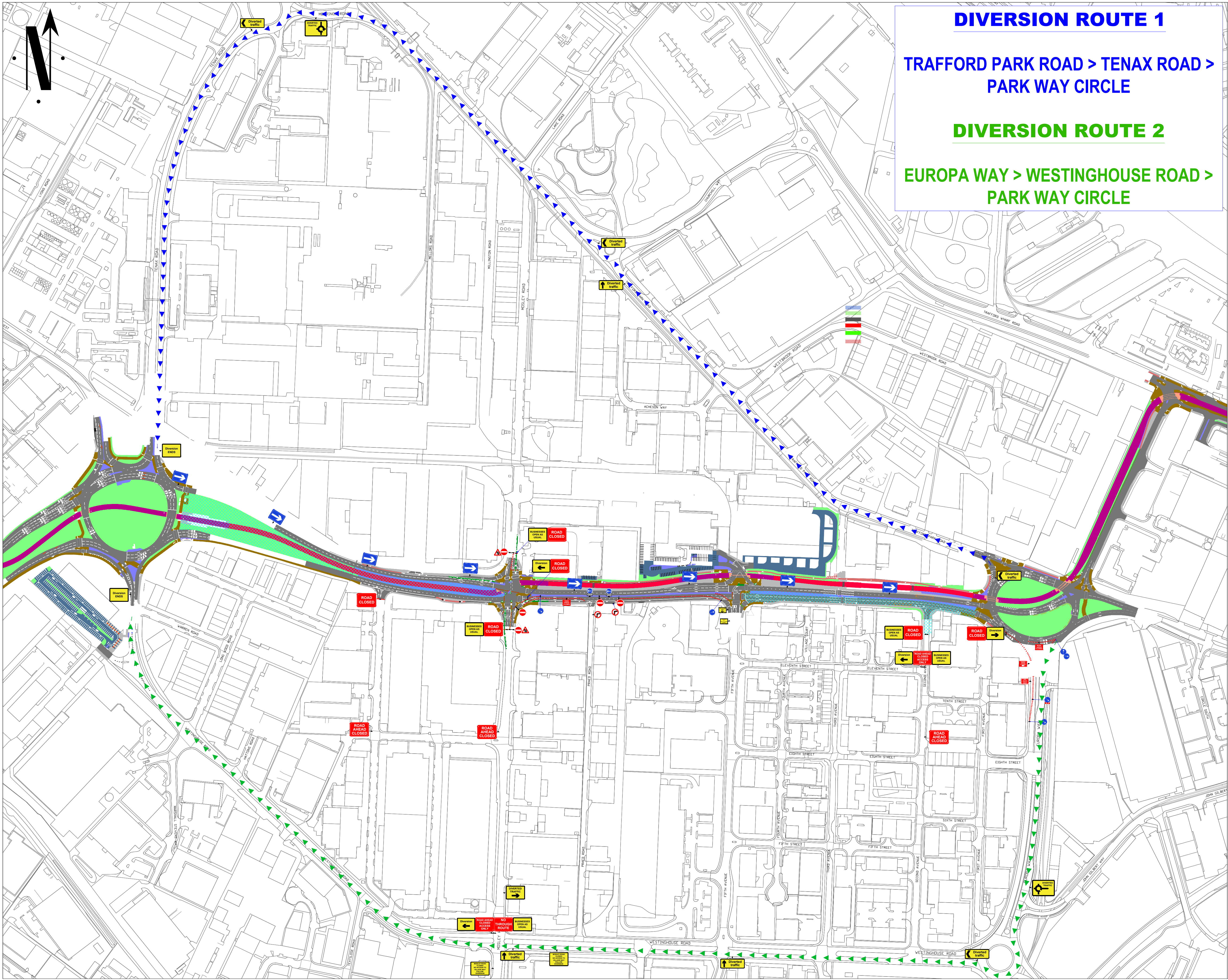

TRAFFIC MANAGEMENT PLAN

- NOTES:
1. All signs as per Chapter 8. Distances between cones to be 9m maximum unless otherwise noted.
 2. Distances between signs NOT to scale for purpose of clarity.
 3. All sign placement subject to available safe working space.
 4. The purpose of the Traffic Management Plan is for it to be used only as a guide and all traffic management equipment should be put out according to the 'Safety at Street Works and Road Works - Code of Practice', i.e. Red Book & the 'Traffic Signs Manual Chapter 8' i.e. Yellow Book

Key

- Sign position and aspect of vision
- Cones
- Barrier (Pedestrian guard)
- Work area
- Diversion Route 1
- Diversion Route 2

This drawing has been produced for a specific project & client identified below and is not intend for use by any other person or for any other purpose

Rev	Description	Date
01	First issue for comment	30.05.17
02	Updated	29.08.19

CODE	SUITABILITY DESCRIPTION
STATUS	PURPOSE OF ISSUE



PROJECT
Manchester Metrolink Phase 3

TITLE
Village Way, Stretford
Temporary One-way System - Westbound Closure
Diversion Route(s)
Section 3.1
Trafford Park Line



DRAWN BY C. Powell	CHECKED BY L. Pilling	DATE 29/08/2019
NTS All dimensions to be verified on site	PROJECT NUMBER MPT3	
DRAWING NUMBER 33119-3.1-0002		REV 02

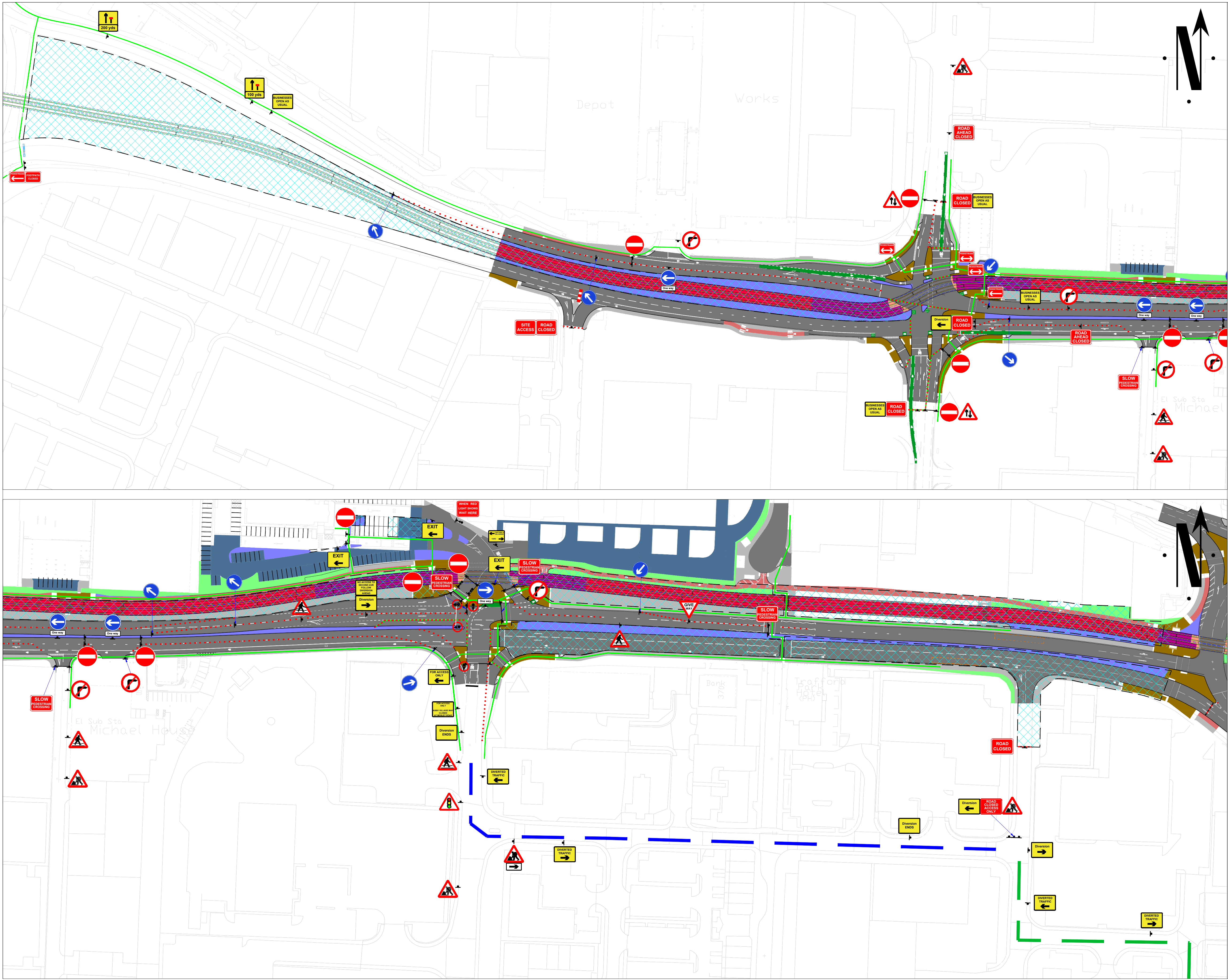

TRAFFIC MANAGEMENT PLAN

- NOTES:
1. All signs as per Chapter 8. Distances between cones to be 9m maximum unless otherwise noted.
 2. Distances between signs NOT to scale for purpose of clarity.
 3. All sign placement subject to available safe working space.
 4. The purpose of the Traffic Management Plan is for it to be used only as a guide and all traffic management equipment should be put out according to the 'Safety at Street Works and Road Works - Code of Practice', i.e. Red Book & the 'Traffic Signs Manual Chapter 8' i.e. Yellow Book

Key

- Sign position and aspect of vision
- Position of signal head
- Cones
- Work area
- Barrier (Siteguard)
- Barrier (Pedestrian guard)
- Pedestrian Route
- Access gate
- Herras fencing

This drawing has been produced for a specific project & client identified below and is not intend for use by any other person or for any other purpose

Rev	Description	Date
01	First issue for comment	10.08.19
03	Updated	28.08.19

CODE	SUITABILITY DESCRIPTION
STATUS	PURPOSE OF ISSUE



PROJECT
Manchester Metrolink Phase 3

TITLE
Village Way, Stretford
Section 3.5
Trafford Park Line
Track & Highway Works (Phase 5c)



DRAWN BY C. Powell	MPT ENGINEER A. Pritchard	CHECKED BY L. Pilling
NTS All dimensions to be verified	PROJECT NUMBER MPT3	DATE 28/08/2019
DRAWING NUMBER 33119-3.6-0016B	REV 03	