

TRAFFORD BOROUGH COUNCIL

THE TRAFFORD (GLEBELANDS ROAD, SALE) (CONSTRUCTION OF ROAD HUMPS) NOTICE 2024

The Borough of Trafford, under powers confirmed by Section 62(3), 90(A), 90(B), 90(C), 90(D) and 90(F) of the Highways Act 1980, as amended by Schedule 10 of the Transport Act 1981, proposes to construct road humps on a road in Sale, in accordance with the Highways (Road Humps) Regulations 1999.

The road humps, which will reduce vehicle speeds, will be 75 mm high speed cushions and will be placed in the vicinity of the following locations:-

SCHEDULE

Glebelands Road, Sale - 75mm Speed Cushions

Approximately 34 metres west of its junction with Carlton Road.

Approximately 50 metres northwest of its junction with Grosvenor Road.

Approximately 13 metres southeast of its junction with Little Ees Lane.

Approximately 70 metres west of its junction with Little Ees Lane.

A map showing the lengths of road referred to may be inspected at Access Trafford, Sale Waterside, Sale, during the normal opening hours and on-line at: www.trafford.gov.uk/trafficregulationorders.

Any objections to the proposals should state the grounds on which they are made and must be made in writing to the address below or at traffordtraffic@amey.co.uk by no later than 4th April 2024.

Dated 14th March 2024.

One Trafford/Trafford Council,
Tatton House,
Caldey Road,
Manchester,
M23 9LF

Abbreviated for papers

**THE TRAFFORD (GLEBELANDS ROAD, SALE) (CONSTRUCTION OF ROAD HUMPS) NOTICE
2024**

The Borough of Trafford, under powers confirmed by Section 62(3), 90(A), (B), (C), (D) and (F) of the Highways Act 1980, as amended, proposes to construct road humps on Glebelands Road, Sale in accordance with the Highways (Road Humps) Regulations 1999.

The 75 mm high speed cushions will be placed on either side of the Glebelands Road/Grosvenor Road junction and will reduce vehicle speeds.

A map showing the lengths of road referred to may be inspected at Access Trafford, Sale Waterside, Sale, during the normal opening hours and on-line at: www.trafford.gov.uk/trafficregulationorders.

Any objections to the proposals should state the grounds on which they are made and must be made in writing to the address below or at traffordtraffic@amey.co.uk by no later than 4th April 2024.

Dated 14th March 2024.

One Trafford/Trafford Council, Tatton House, Caldey Road, Manchester, M23 9LF

STATEMENT OF REASON

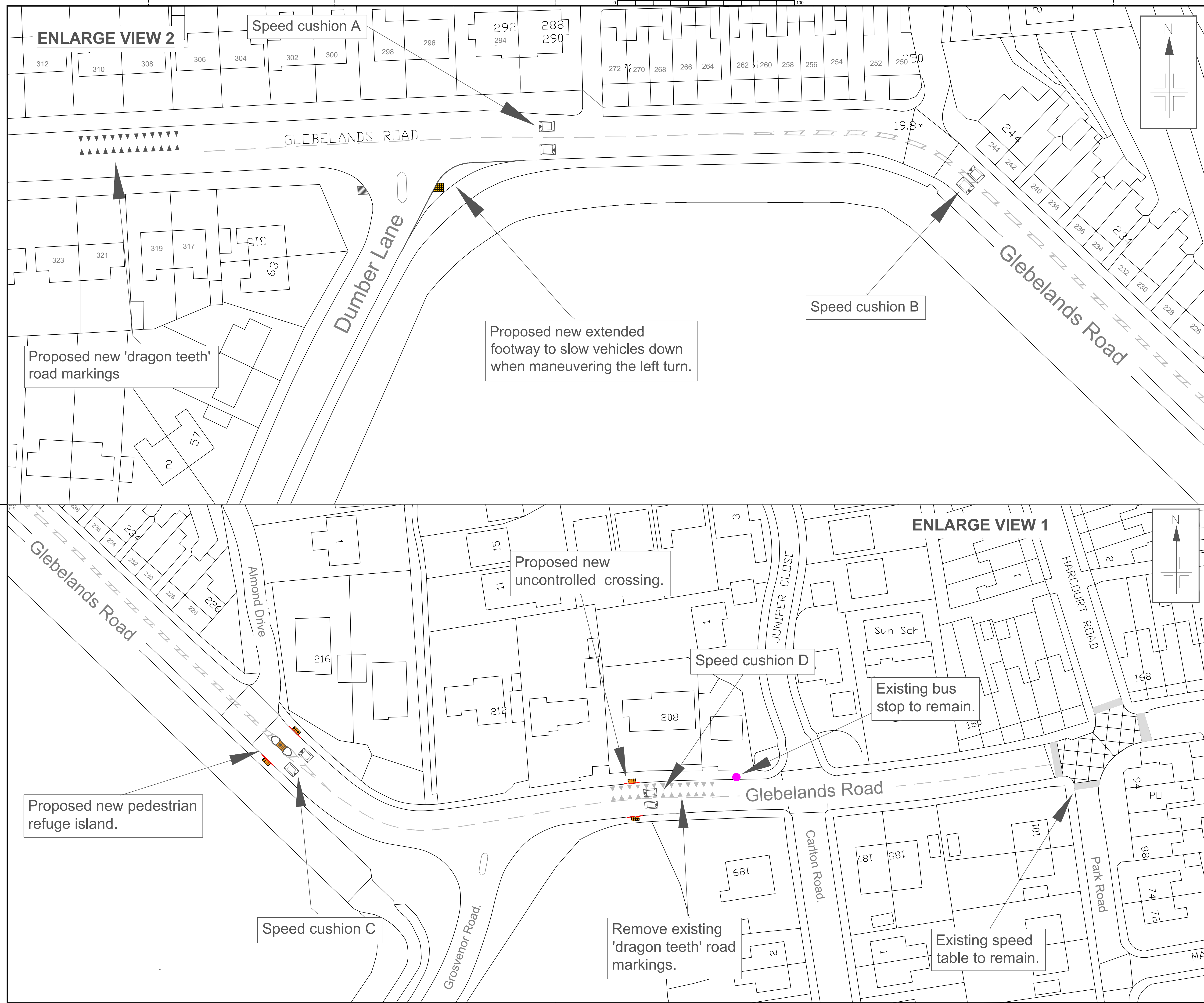

The Council has been contacted by residents to address issues of road safety on Glebelands Road, Sale in particular the section between Dumber Lane and Park Road. A section of Glebelands Road was partially traffic calmed around 2003, as part of a local safety scheme and the features ended at that time around its junction with Park Road. In more recent years numerous complaints have been received about the inappropriate speed of vehicles travelling along the section that has no traffic calming. There are concerns relating to collisions occurring at the bend near the junction of Grosvenor Road and along the section adjacent to Ashton Park.

The Council previously proposed to install a mini roundabout located at the junction of Grosvenor Road and Glebelands Road, to help improve pedestrian safety and to reduce vehicle speeds around the bend however having reassessed the circumstances, it is proposed to introduce additional traffic calming measures in the form of 'speed cushions' on Glebelands to improve pedestrian access and road safety for all road users

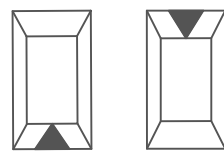
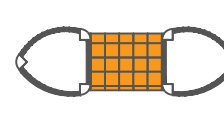

ENLARGE VIEW 2

ENLARGE VIEW 1

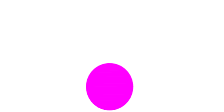
- KEY**
-  Proposed new speed cushions, refer to speed cushion A-D.
 -  Proposed new pedestrian refuge island.
 -  Proposed new 'dragon teeth' road markings.
 -  Existing 'dragon teeth' road markings to be removed.
 -  Existing bus stop to remain.

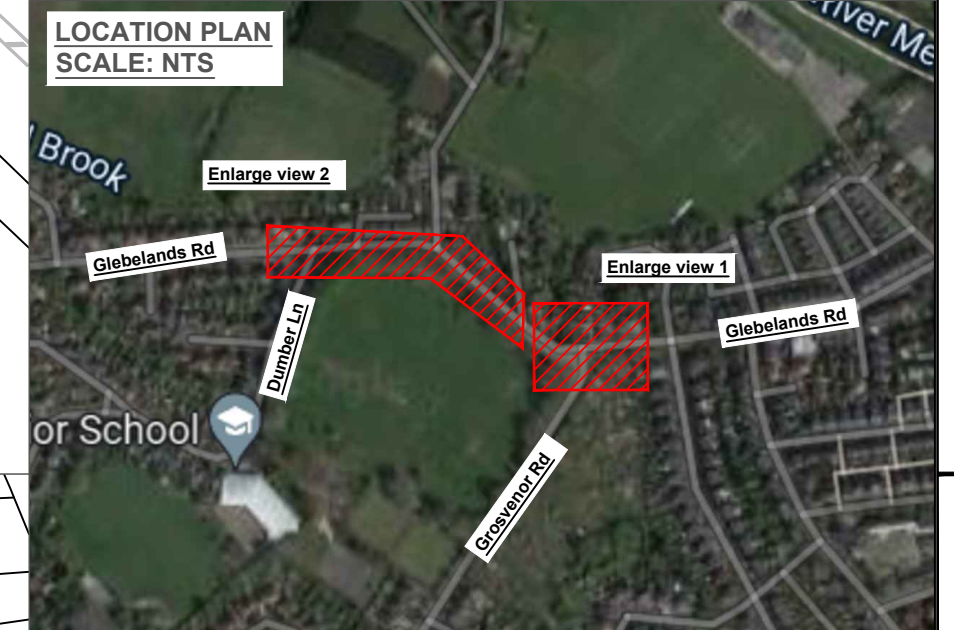

© Crown copyright [and database rights] 2023 OS 100023172. You are permitted to use this data solely to enable you to respond to, or interact with, the organisation that provided you with the data. You are not permitted to copy, sub-license, distribute or sell any of this data to third parties in any form.

Rev	Revision details	Drwn	Chkd	Appd	Date
A	Altered the text and added a bus stop and remove existing dragon teeth.	AK	TC	KH	29/11/23
Designed: AK		Date: 06/09/23			
Drawn: AK		Date: 06/09/23			
Checked: TC		Date: 06/09/23			
Approved: KH		Date: 06/09/23			



Project Name	E9101- GLEBELANDS ROAD & DUMBER LANE
Drawing Title	CONSULTATION PLAN

Original Drawing Size : A1	Scale : NTS	
Dimensions : M		
Drawing Status	CONSULTATION PLAN	Suitability
Drawing No	E9101- 025	Rev
		A