

**ROAD TRAFFIC REGULATION ACT 1984**

**BOROUGH OF TRAFFORD (GRANGE ROAD, FLETCHER DRIVE, SOUTH DOWNS ROAD AND YORK ROAD, BOWDON)(TEMPORARY PROHIBITION OF WAITING) ORDER 2014**

**NOTICE IS HEREBY GIVEN** that, in order to prohibit obstructive parking and maintain access for construction traffic and to maintain public safety during nearby building works, Trafford Borough Council intends, not less than seven days from the date of this notice, to make an Order the effect of which will be to prohibit waiting as follows:-

**NO WAITING AT ANY TIME**

- Fletcher Drive, Bowdon - Both sides - from its junction with Grange Road for a distance of 10 metres
- Grange Road, Bowdon - West Side - from a point 10 metres south of its junction with Langham Road for a distance of 15 metres
- West side - from a point 15 metres north of its junction with York Road to the access road to Grange Court
- West side - from the southerly access road to the garages of Grange Court to a point 8 metres south of its junction with Fletcher Drive
- West side - from a point 30 metres south of its junction with Fletcher Drive around the cul-de-sac end to its junction with its easterly side
- East side - from its junction with South Downs Road for a distance of 256 metres
- East side - from a point 367 metres south of its junction with South Downs Road around the cul-de-sac end to its junction with its westerly side
- South Downs Road, Bowdon – North side - from its junction with Langham Road for a distance of 24 metres
- South side – from its junction with Grange Road for a distance of 10 metres
- York Road, Bowdon - Both sides - from its junction with Grange Road for a distance of 10 metres

**NO WAITING MONDAY – FRIDAY 8AM – 5PM**

- Grange Road, Bowdon - West side - from a point 25 metres south of its junction with Langham Road for a distance of 144 metres
- West side - from a point 194 metres south of its junction with Langham Road for a distance of 37 metres
- West side - from a point 8 metres south of its junction with Fletcher Drive for a distance of 22 metres
- Grange Road, Bowdon - East side - from a point 288 metres south of its junction with South Downs Road for a distance of 15 metres

The Order will come into operation on 19<sup>th</sup> September 2014 and will remain in force for a period not exceeding 18 months.

Dated: 3<sup>rd</sup> September 2014

Head of Highways,  
Trafford Borough Council,  
Waterside House,  
Sale,  
M33 7ZF

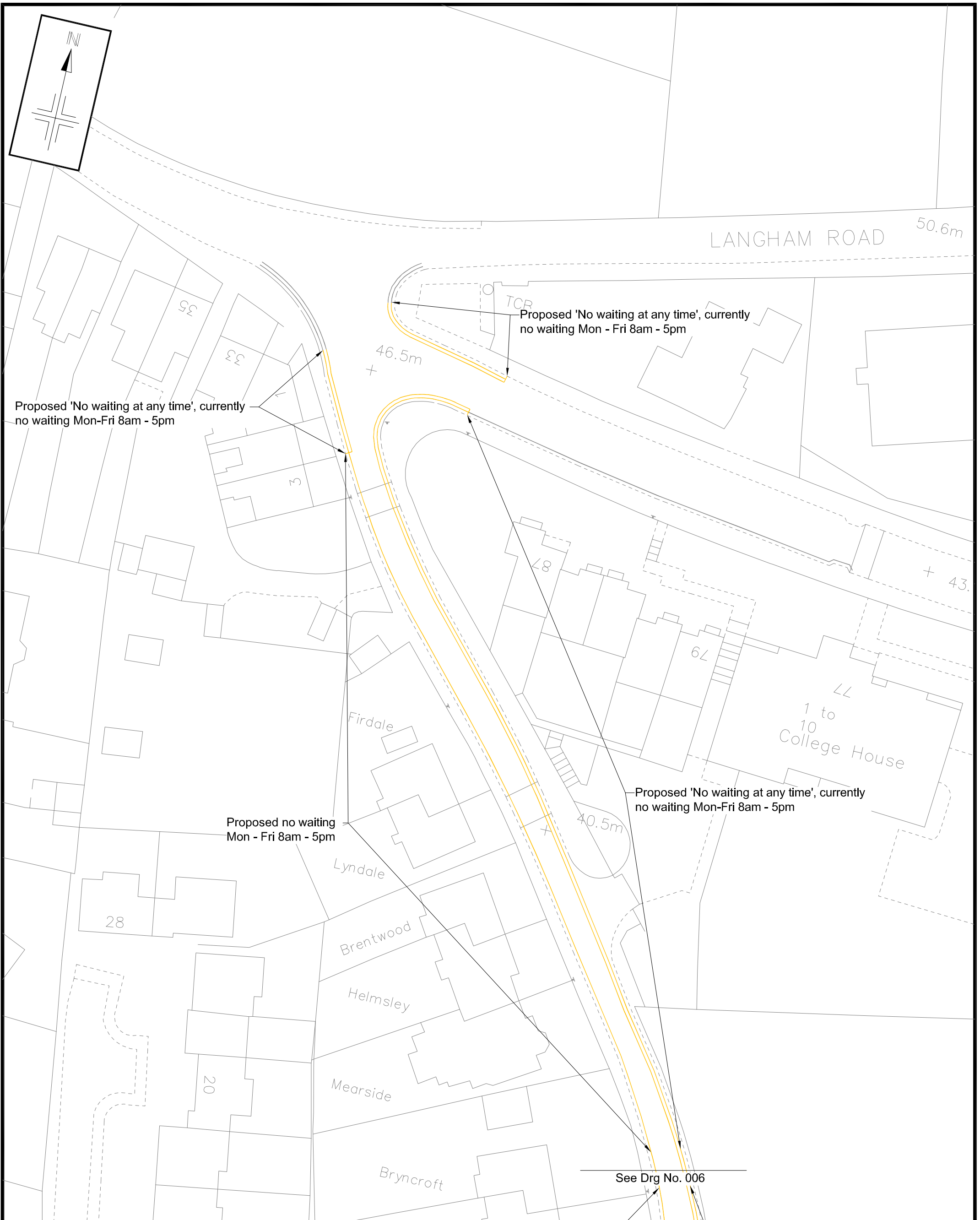

Notes:  
 No Dimensions to be scaled from this drawing.  
 All Dimensions are to be checked on site.

Trafford Borough Council OS Licence No. 4076392 1399

REV.	DATE	REVISION DETAILS	DRAWN	CHECKED	APPROVED
			SG	AH	AH

Grange Road Area, Bowdon  
 Bowdon C of E School  
 Consultation Plan Sht 1 of 3



DRAWN SG	CHECKED AH	APPROVED AH
SCALE 1:500@A3	DRAWING NO. 398-233-005	
DATE 19.08.14	REVISION A	

R:\BU\Env\BEIT&TIC&D Photographs\

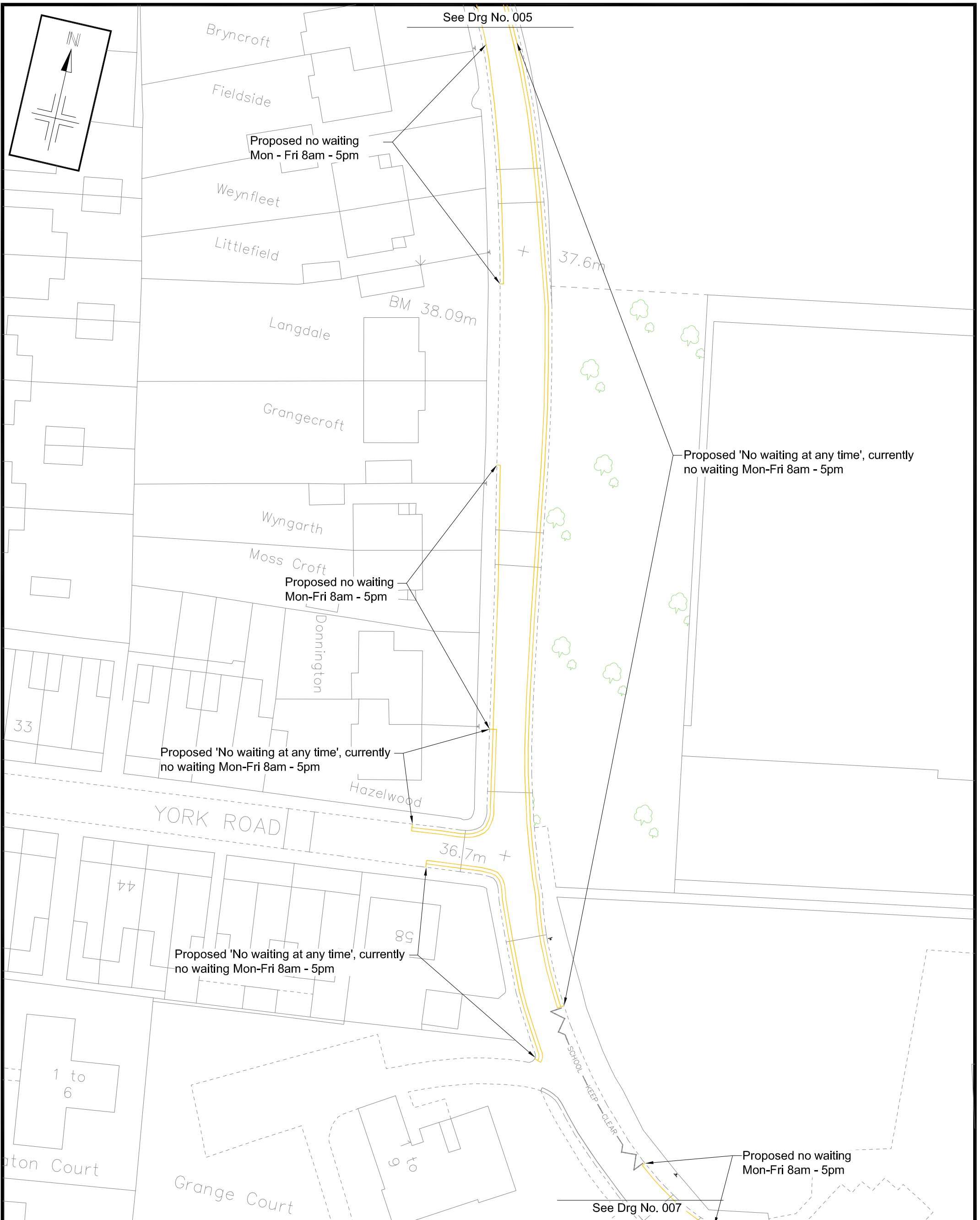

Notes:  
No Dimensions to be scaled from this drawing.  
All Dimensions are to be checked on site.

Trafford Borough Council OS Licence No. 4076392 1399

REV.	DATE	REVISION DETAILS	DRAWN	CHECKED	APPROVED
			SG	AH	AH

Grange Road Area, Bowdon  
Bowdon C of E School  
Consultation Plan Sht 2 of 3



DRAWN SG	CHECKED AH	APPROVED AH
SCALE 1:500@A3	DRAWING NO. 398-233-006	
DATE 19.08.14	REVISION A	

R:\BUE\Env\BEIT&TIC&D Photographs\

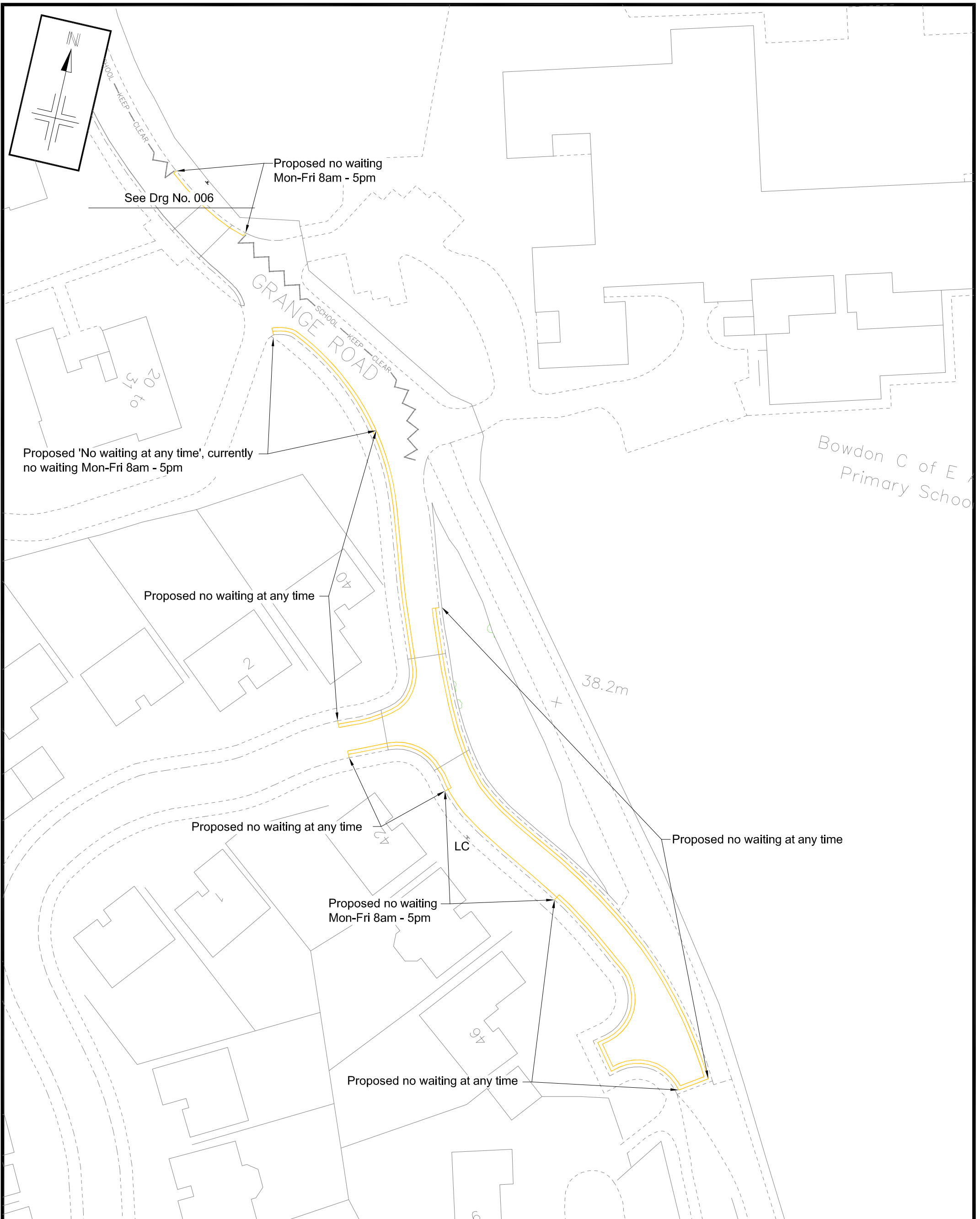

Notes:  
No Dimensions to be scaled from this drawing.  
All Dimensions are to be checked on site.

Trafford Borough Council OS Licence No. 4076392 1399

REV.	DATE	REVISION DETAILS	DRAWN	CHECKED	APPROVED
			SG	AH	AH

Grange Road Area, Bowdon  
Bowdon C of E School  
Consultation Plan Sht 3 of 3



SCALE 1:500@A3	DRAWING NO. 398-233-007	REVISION A
DATE 19.08.14		

R:\BU\Env\BEIT&TIC&D Photographs\