

White City,
Old Trafford,
MANCHESTER.

26th. February, 1908.

E. Worrall, Esq.,
Surveyor,
Council Offices,
OLD TRAFFORD.

Dear Sir,

RE WHITE CITY RECONSTRUCTION.

In reply to your favour of even date, I beg to confirm our undertaking to confirm with your express desire in this letter at hand.

With regard to the Chester Road side of the Scenic Railway, will say that we should like very much to leave our traffic on this side in view until after it has been given a test, and if it does annoy the traffic in the streets we will, of course, then shield it. If this is Satisfactory I should like to have an expression from you.

Thanking you for the prompt way in which you have come to our assistance.

Yours truly,

J. C. BROWN.

J.C.B.

THE WHITE CITY Limited,
 OLD TRAFFORD,
 MANCHESTER.

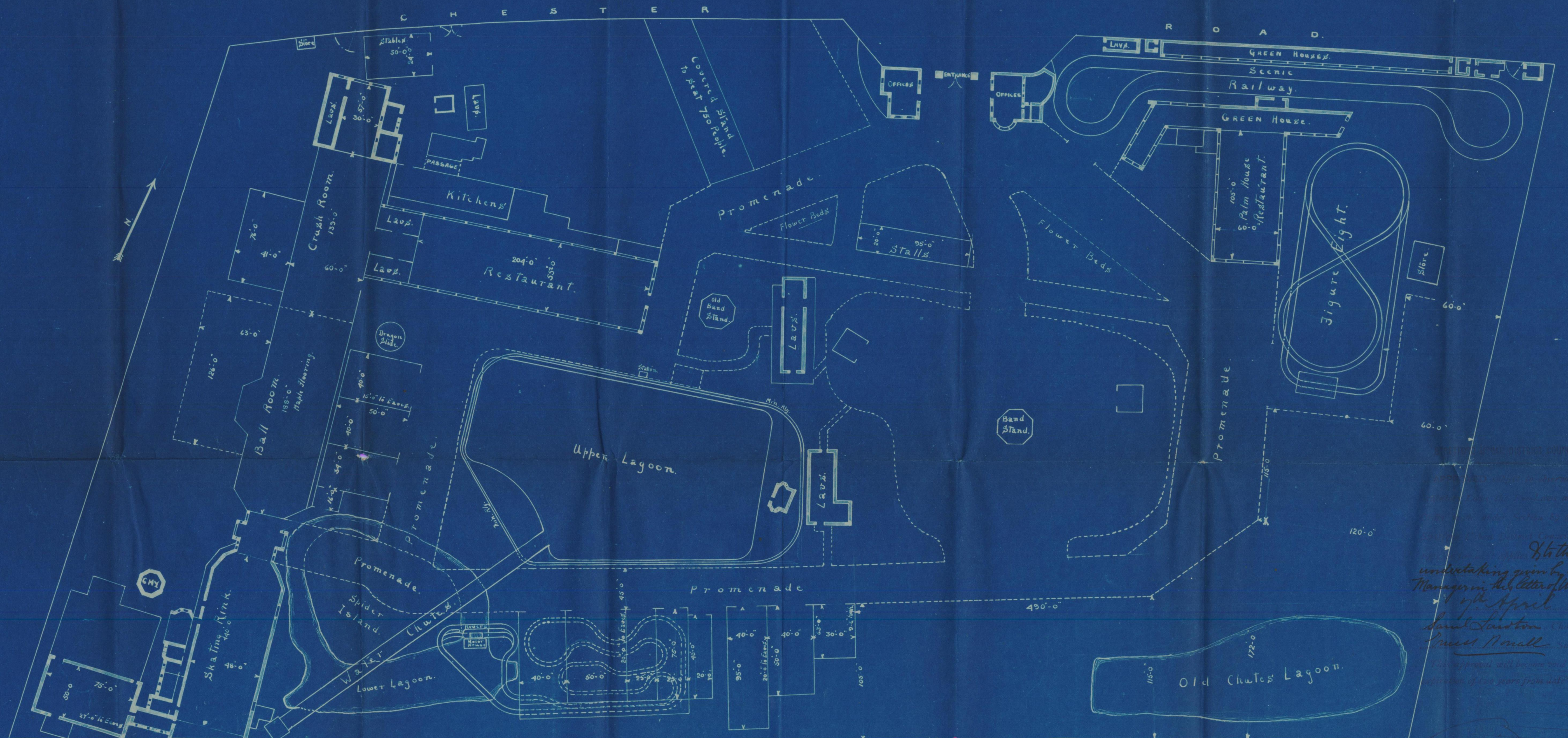

Approved by the General Manager of the White City Limited, Manchester, on the 10th day of April 1908.

Witness my hand and seal this 10th day of April 1908.

James M. ...

The approval will become void in expiration of two years from date hereof.

1840

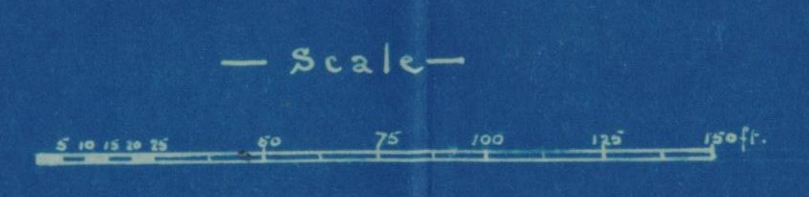

BRICK BUILT BUILDINGS INDICATED BY ————
 TIMBER BUILT BUILDINGS INDICATED BY - - - - -
 TIMBER & GLASS BUILT BUILDINGS INDICATED BY — · — · —
 RAILINGS & TRAILIS WORK INDICATED BY - - - - -

W. H. ...
 5-2-08